

	REVISION RECORD MODIFICATIONS	DATE	REV.
		2014/03/11	V/0
△	NEW		

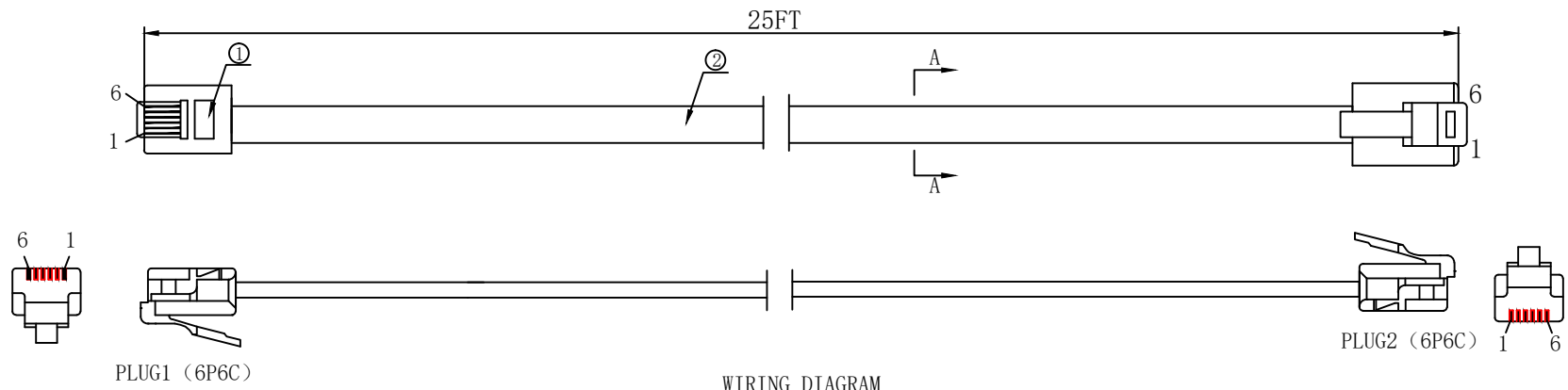

WIRING DIAGRAM

PLUG1 (6P6C)	PLUG2 (6P6C)
1 — WHITE — 1	1 — WHITE — 1
2 — BLACK — 2	2 — BLACK — 2
3 — RED — 3	3 — RED — 3
4 — GREEN — 4	4 — GREEN — 4
5 — YELLOW — 5	5 — YELLOW — 5
6 — BLUE — 6	6 — BLUE — 6

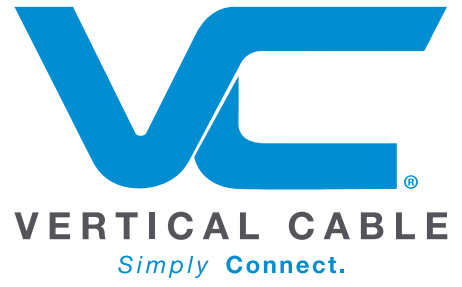
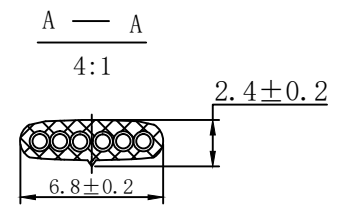

NOTES:

- 1. Electrical testing:100%
- 2. Visual inspection:100%
- 3. ROHS Compliant

MATERIAL LIST:

						DRAW NO.	PRODUCT NAME		
②	CABLE	JACKET:PVC COLOR:SILVER GRAY OD:6.8*2.4 6C;INS:PP OD:0.98MM COLOR: WHITE/BLACK/RED/GREEN/YELLOW/BLUE;CONDUCTOR:7*0.12CCA	1Pcs			CUSTOMER		VIEW	TOLERANCE
						ITEM NO.	091-716/6C/25S		X. ±1.00 X.X ±0.50
①	US PLUG	FU" 6P6C (APERTURE:1.0-1.05) (SQUARE HOLE)	2Pcs			DRAWNBY	CHECKBY		UNTT MM
NO.	MAT. NAME	DESCRIPTION	QT'Y	REMARK					Blatt-Nr. 1/1