

SHIELDED INLINE COUPLER

Category 6A

SKU: 040-370/C6A/S



DESCRIPTION

CAT6A RJ45 female to RJ45 female Shielded In-line Coupler

FEATURES

- Shielded RJ45 female to RJ45 female Inline Coupler is used to connect two network patch cables to make a longer cable.
- Protects signal from excess EMI

Material:

RJ45 Jack

| | |
|-----------------|---------------|
| Housing | ABS, UL 94V-0 |
| Contact Bracket | PC, UL 94V-2 |

RJ45 Jack Contact

| | |
|----------|---|
| Material | Phosphor Bronze, Nickel Plated |
| Finish | 50micro inch Gold plated on Plug contact area |
| PCB | FR4, UL 94V-0 |

Performance:

| | |
|--------------------------|--|
| Insertion Force | 30N max (IEC 60603-7-4) |
| Retention Strength | 7.7kg between Jack and Plug |
| Operating Temp | -10°C - 60°C (ISO/IEC 11801, ANSI/TIA/EIA 568B.2) |
| Life (mating cycles) | 750 cycles min (ISO/IEC 11801, IEC 60603-7-5) |
| Transmission Performance | TIA/EIA 568C.2 Standard 10G & ISO/IEC 11801 Standard |

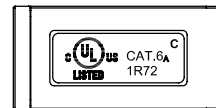
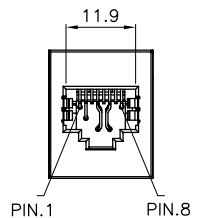
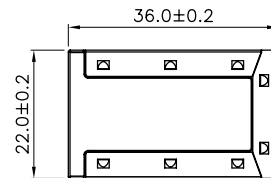
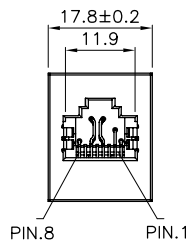

VERTICAL CABLE
951.696.7772 California
800.749.2447 Florida
845.391.8318 New York



www.verticalcable.com

Rev. 01/2018
Subject to change without notice.